

**NOTICE OF PUBLIC HEARING
HAMBURG TOWNSHIP
LIVINGSTON COUNTY, MICHIGAN
NOTICE OF PUBLIC HEARING
UPON SPECIAL ASSESSMENT ROLL FOR THE
DOWNING DRIVE ROAD MAINTENANCE PROJECT
SPECIAL ASSESSMENT DISTRICT**

NOTICE IS HEREBY GIVEN:

(1) The Township Board of the Township of Hamburg, Livingston County, Michigan (the "Township") has determined to levy special assessments against lands in the DOWNING DRIVE ROAD MAINTENANCE SPECIAL ASSESSMENT DISTRICT (the "District") that will be benefited by the road maintenance services to be provided for the District. The District consists of the lands identified in the map attached to this notice and is more specifically identified by the following permanent parcel numbers:

15-28-203-054	15-28-203-057	15-28-203-058	15-28-203-060
15-28-402-001	15-28-402-002	15-28-402-010	15-28-402-011
15-28-402-012	15-28-402-013	15-28-402-014	15-28-402-015
15-28-402-016	15-28-402-017	15-28-402-018	15-28-402-019
15-28-402-021	15-28-402-022	15-28-402-023	15-28-402-024
15-28-402-025	15-28-402-058	15-28-402-059	15-28-402-065
15-28-402-068	15-28-402-069	15-28-402-070	15-28-410-001
15-28-410-002	15-28-402-003	15-28-410-004	

(2) The proposed special assessment roll for the District (the "Roll") has been prepared and is now on file in the office of the Township Clerk and is available at such office for public examination during the hours the Township Hall is regularly open to the public for business.

(3) The Township Board will conduct a public hearing beginning at 5:00 p.m., local time on Tuesday, March 17, 2020, at the Hamburg Township Hall, 10405 Merrill Road, Hamburg, Michigan to explain and answer questions pertaining to the Roll and to hear objections to the Roll. Any person objecting to the Roll must file his or her objections in writing before the close of the public hearing or within such additional time (if any) as the Township Board may grant.

(4) The owner or other person having an interest in property that is specially assessed is entitled to file a written appeal with the Michigan Tax Tribunal within 30 days after confirmation of the Roll. However, appearance and protest at the public hearing are required by law in order to appeal the special assessment to the Michigan Tax Tribunal. An owner or other party in interest or his or her agent must file an objection in writing with the Township Clerk before the close of the hearing.

The Township Board will maintain a record of the persons who appear and protest at the hearing. If the hearing is terminated or adjourned for the day before a party is provided the opportunity to be heard, a party whose appearance was so recorded shall be considered to have protested the special assessment in person.

This notice is given by order of the Hamburg Township Board.

Dated: March 4th, 2020

Michael Dolan
Hamburg Township Clerk
10405 Merrill Rd. P.O. Box 157
Hamburg, MI 48139

Downing Drive Road Maintenance Project
Hamburg Township, Livingston County, Michigan

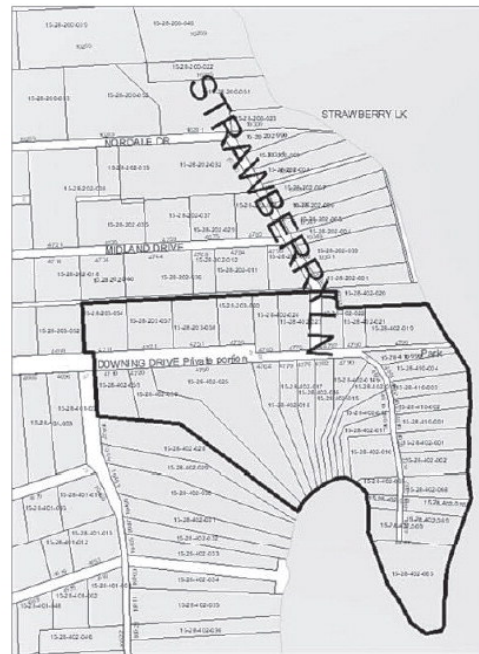

Downing Drive Road Maintenance Special Assessment District (SAD) boundary shown within thick black-lined area.

(03-04/11-2020 DAILY 355619)